

DESCRIPTION

JM Stainless Steel Sure-Fit or Ell-Jacs® Insulation Fitting Covers are made in two precision formed matching halves and are sized to cover and weatherproof insulated 90° and 45° elbows along pipelines. They are manufactured from Type-316 Stainless Steel in .016" thickness. They can be used on long and short radius, butt weld, socket weld, and screwed pipe elbows from 1/2" to 10" Iron Pipe Size, inclusive.

Type 316 alloy has a melting point of approximately 2500° and consists of 16% chromium, 10% nickel, and 2% molybdenum.

ADVANTAGES

JM Stainless Steel Sure-Fit/Ell-Jac elbows are the closest fitting elbow insulation covers available from any source. They are designed to allow for a 7/16" circumferential overlap, and are manufactured to conform to ASTM C-450 Method of Fabrication and ASTM C-585 (table 7A) Outer Diameters of Insulation. Descriptive labels are affixed to the underside of the fittings identifying interchangeable sizes, rather than listing only one size. This information can help you save valuable inventory space and allows greater flexibility on the jobsite.

RECOMMENDED USES

JM Stainless Steel Sure-Fit/Ell-Jac insulation elbow covers should be used in areas of heavy mechanical abuse and where corrosion and high temperatures are factors.

SUGGESTED SPECIFICATIONS

All 90° and 45° insulated elbows having a nominal iron pipe size of 1/2" to 10" inclusive (max 14" O.D.) can be protected with Sure-Fit or Stainless Steel Ell-Jacs® manufactured from Type-316 Stainless Steel in .016" thickness. The elbows should be installed in accordance with MICA (Midwest Insulation Contractors Association) standards

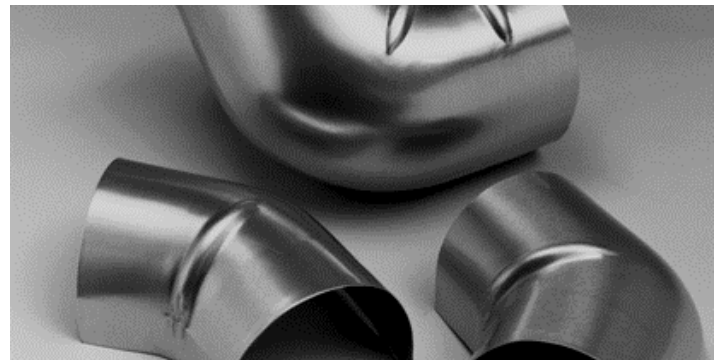

INSULATION SIZE O.D. CHART

| IPS | 1" | 1½" | 2" | 2½" | 3" |
|-----|--------|--------|-------|--------|--------|
| ½" | 3 | 4.25 | 5.125 | 6.875 | 8 |
| ¾" | 3 | 4.25 | 5.125 | 6.875 | 8 |
| 1" | 4 | 4.75 | 5.812 | 6.875 | 8 |
| 1¼" | 4 | 5.187 | 5.812 | 6.937 | 8 |
| 1½" | 4.25 | 5.187 | 6.937 | 8 | 8.75 |
| 2" | 4.625 | 5.812 | 6.937 | 7.875 | 8.75 |
| 2½" | 5.25 | 6.812 | 7.875 | 8.75 | 9.875 |
| 3" | 5.687 | 6.937 | 7.75 | 8.75 | 9.875 |
| 3½" | 7.0 | 8 | 8.875 | 10 | 11.125 |
| 4" | 7.0 | 8 | 8.875 | 10 | 11.125 |
| 4½" | 7.937 | 8.875 | 10 | 11.062 | 12.062 |
| 5" | 7.937 | 8.875 | 10 | 11.062 | 12 |
| 6" | 9 | 10.125 | 11 | 12 | 13.25 |
| 7" | 10.125 | 11 | 12 | 13.25 | 14.50 |
| 8" | 11.125 | 12.25 | 13.25 | 14.50 | 15.50 |
| 9" | 12.25 | 13.25 | 14.50 | 15.50 | |
| 10" | 13.25 | 14.50 | | | |

O. D. chart provides information on the maximum O.D. JM Sure-Fit/Ell-Jac elbows will fit after allowing for a 7/16" overlap. There is an allowance for insulation that is oversized when measured against Table 3-A, ASTM C-585 designation.

Formerly Pabco/Childers Metals



717 17th St.
Denver, CO 80202
(800) 866-3234
JM.com

Technical specifications as shown in this literature are intended to be used as general guidelines only. Please refer to the Safety Data Sheet and product label prior to using this product. The physical and chemical properties of the product listed herein represent typical, average values obtained in accordance with accepted test methods and are subject to normal manufacturing variations. They are supplied as a technical service and are subject to change without notice. Any references to numerical flame spread or smoke developed ratings are not intended to reflect hazards presented by these or any other materials under actual fire conditions. Check with the Regional Sales Office nearest you for current information.

All Johns Manville products are sold subject to Johns Manville's standard Terms and Conditions, which includes a Limited Warranty and Limitation of Remedy. For a copy of the Johns Manville standard Terms and Conditions or for information on other Johns Manville thermal insulation and systems, visit www.jm.com/terms-conditions or call (800) 654-3103.